

Installation and Operating Instruction for B.E.G. - Occupancy detectors PD2-DIM-KNX/EIB-SM/-FC/-FM, PD4-DIM-KNX/EIB-SM/-FC, PD9-DIM-KNX/EIB-FC, Indoor 180-DIM-KNX/EIB-FM

1a. Installation of the LUXOMAT® PD2/PD4-DIM-KNX/EIB-SM

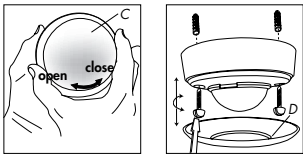

The detector must be installed on a solid and level surface. The circular cover ring must be removed prior to assembly. To do this, twist the lens (C) of the PD4-DIM-KNX/EIB or (D) of the PD2-DIM-KNX/EIB anticlockwise through approximately 5° and lift off.

Having connected up the wires in accordance with regulations, secure the detector with 2 screws. After installation replace the lens and lock (turn clockwise). Mains to be connected.

1b. Installation of the LUXOMAT® PD2/PD4/PD9-DIM-KNX/EIB-FC

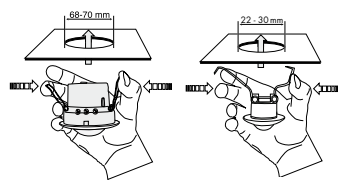

The detector has been designed and developed specifically for installation in suspended ceilings. A circular opening of diameter 68 – 70 mm (PD2/PD4-DIM-KNX/EIB) resp. 30 mm (PD9-DIM-KNX/EIB) must be produced in the ceiling.

Having connected up the cables in accordance with regulations, the detector is inserted into the opening as shown in the drawing opposite and fixed into position with the assistance of the spring clips.

1c. Installation of the LUXOMAT® PD2-DIM-KNX/EIB-FM

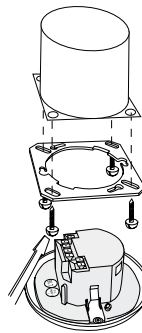

The detector can be installed in conventional inlet-sockets mounted on the ceiling. The assembly plate enclosed must be stripped off prior to installation and secured to the ceiling using 4 screws and ensuring that it is not laterally transposed.

Having connected up the cables in accordance with regulations, the detector can be placed in position as shown in the drawing opposite and, applying a little pressure, can then be locked into position with the assistance of the spring clips.

1d. Installation of the LUXOMAT® Indoor 180-DIM-KNX/EIB-FM

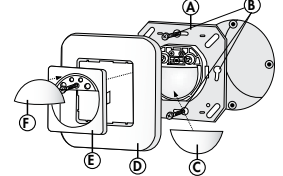

The detector can be installed in conventional installation sockets. Installation should be made to a wall with a height of 1.1 to 2.2 m.

Before installation, the hemispherical covering-cap (F) above the lens and the mask (E) below it need to be removed using a small screwdriver. After connecting the cables in accordance with the regulations, fasten sensor (A) using 4 screws as in the sketch below.

For installation outdoors, the IP54 installation set (Part-Nr. 92141) is available as an accessory.

2. Range of Coverage

- 1 Walking across
- 2 Walking towards
- Seated

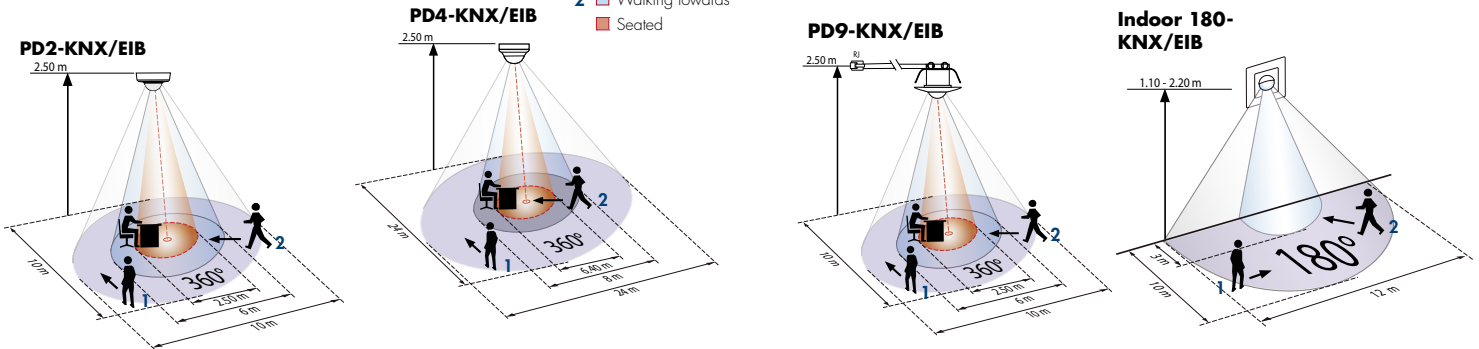

3. Putting into operation / Settings

In connection with the application program BEG_DIM_HKL_V3.1 there are 4 different modes available. The application has already been loaded. Please load the following data partially:

- physical address
- group address
- parameter

Product data bank to be imported in the ETS data base is included in the delivery or can be downloaded from the **B.E.G.** homepage.

Attention: Please do not locate the detector near a heating or air condition source!

Please refer to the application description for details of application programming and the communication objects!

4. Article / Part-Nr. / Accessory

Type	SM	FC	FM
PD2-DIM-KNX/EIB	92430	92431	92432
PD4-DIM-KNX/EIB	92433	92434	92435
PD9-DIM-KNX/EIB	-	92437	-
Indoor 180-DIM-KNX/EIB (Sensor insert)	-	-	92436

Accessory:

BSK Ball basket guard	white	92199
FC-Covering IP23	transparent	92206
SM-Socket IP54 PD2-KNX/EIB	white	92161
SM-Blinds PD4	transparent	92260
Cover ring PD9	white	92238
Cover ring PD9	silver	92237
Cover ring PD9	black	92235
Covering Indoor 180	RAL9010	92630
Covering Indoor 180	RAL9016	92631
Covering Indoor 180	RAL1013	92632
Covering Indoor 180	RAL9006	92633
Covering Indoor 180	RAL7021	92634
Covering IP54 Indoor 180	RAL9010	92139
SM-Socket Indoor 180	RAL9010	92141

5. Technical data DIM-KNX/EIB

Sensor and power supply in one case
Power supply: 24VDC from DIM-KNX/EIB-BUS system
Current absorption: 10 mA
Ambient temperature: 0°C – +35°C
Degree of protection/class:
 PD2/PD4-DIM-KNX/EIB SM IP20 with accessory IP54, FC and FM IP20, FC with accessory IP23 / II
 PD9-DIM-KNX/EIB IP20 / II
 Indoor 180-DIM-KNX/EIB IP20, with accessory IP54 / II

Settings: by ETS-system
 (Product data bank to be imported in the ETS data base is included in the delivery or can be downloaded from the **B.E.G.** homepage.)

Area of coverage:
 PD2/PD4/PD9-DIM-KNX/EIB circular 360°
 Indoor 180-DIM-KNX/EIB semicircular 180°

Range of coverage:
 PD2/PD9-DIM-KNX/EIB max. 10 m (walking across)
 PD4-DIM-KNX/EIB max. 24 m (walking across)
 Indoor 180-DIM-KNX/EIB max. 8 m (walking towards)

Recommended height for mounting:
 PD2/PD4/PD9-DIM-KNX/EIB 2 - 3 m
 Indoor 180-DIM-KNX/EIB 1.1 - 2.2 m

Light measure: mixed light, daylight + artificial light

Dimensions PD2/PD4/PD9 H x Ø [mm]:

	SM	FC	FM
PD2-DIM-KNX/EIB	50 x 97	84,5 x 74	65 x 98
PD4-DIM-KNX/EIB	73 x 100	97 x 103	-
PD9-DIM-KNX/EIB	-	40 x 45	-

Visible portion when built into ceiling:
 PD2-DIM-KNX/EIB 34 x 74 mm
 PD4-DIM-KNX/EIB 34 x 103 mm
 PD9-DIM-KNX/EIB 12 x 45 mm

Dimensions Indoor 180-DIM-KNX/EIB:
 H 87 x W 87 x D 61 mm

CE Declaration of Conformity: The product complies with the low voltage recommendation 2006/95/EC and the EMV recommendation 2004/108/EC

6. DIM-KNX/EIB - Connections

